

 **SENNHEISER**

Broadcast
HME 26(4)



Instruction manual

Safety instructions

- Please read these instructions carefully and completely before using the headset.
- Make these instructions easily accessible to all users at all times.
- Always include these instructions when passing the product on to third parties.
- The product is capable of producing sound pressure levels exceeding 85 dB(A). In many countries 85 dB(A) is the maximum legally permissible level for continuous noise exposure during the working day. Exposure to sounds of higher volume levels or for longer durations can permanently damage your hearing!
- Never repair or attempt to repair a defective product yourself. Contact your Sennheiser agent or the Sennheiser Service Department.
- Only replace those parts of the product whose replacement is described in this manual. All other parts must be replaced by your Sennheiser agent.
- Protect the product from wetness. Use only a slightly damp cloth for cleaning. For information on how to clean the product, contact your Sennheiser agent.

Intended use

Intended use includes:

- having read this instruction manual especially the chapter “Safety instructions” on page 1.
- using the product within the operating conditions as described in this instruction manual.

Improper use means using the headset other than as described in this instruction manual, or under operating conditions which differ from those described herein.

Delivery includes

1 headset

1 cable clip

1 wind and pop screen for indoor use

1 wind and pop screen for outdoor use

1 instruction manual

HME 26

The HME 26 headsets feature dynamic, closed headphones. The noise-compensating microphone ensures excellent speech transmission even in noisy environments. The headsets have been designed for broadcast use, e.g. for outdoor broadcast or broadcast van applications. The microphone has a cardioid pick-up pattern.

Features

- Lightweight
- Extremely comfortable to wear, even for extended listening, due to the patented two-piece automatic headband and soft ear pads
- ActiveGard™ (switchable) safeguards you from volume peaks above 105 dB
- “Flip-away” headphone allows single-sided listening
- Detailed, linear sound reproduction for demanding applications
- Flexible microphone boom, can be worn on either left or right-hand side
- Noise-compensating pre-polarized condenser microphone ensures excellent speech transmission
- Single-sided cable
- Cable is easy to exchange

Operation

Turning the microphone boom

The microphone boom can be rotated by 180°. This allows the headset to be worn with the microphone boom positioned on either the left or right-hand side of the head.

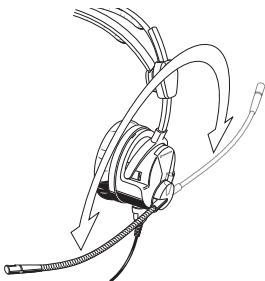

Switching the microphone transmission off

If, during turning, the microphone boom is in the middle position (90°), the microphone transmission will be switched off in order to prevent disturbing noise.

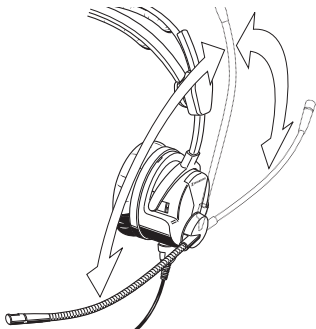

Putting on the headset

When putting on the headset, the patented two-piece headband adjusts automatically.

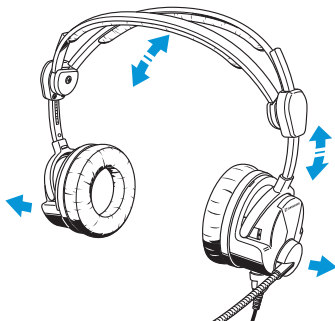

Positioning the microphone

Bend the flexible microphone boom so that the microphone is placed at the corner of the mouth. Maintain a distance of approx. 2 cm between microphone and mouth. Always use the supplied wind and pop screen.

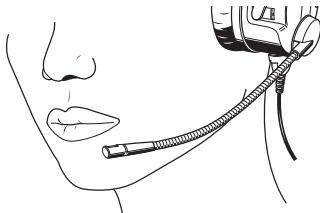



Do not position the microphone directly in front of your mouth as it will pick up your breathing and plosive noises from your mouth. In addition, moisture can adversely affect the sound and performance of your microphone.

When attaching the sound inlet basket, make sure that it locks into place with an audible click.

Make sure not to cover the sound inlet.

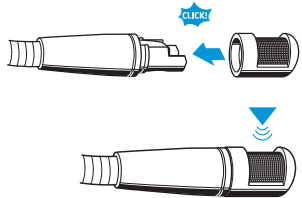

Flipping away one earcup

The headset features a “flip-away” earcup for single-sided listening.

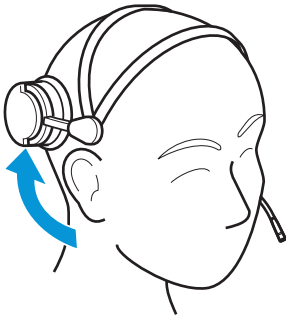

Adjusting the volume directly on the audio system

Connect the headset to the corresponding sockets of your audio system. Adjust the volume directly on the audio system.

CAUTION! Hearing damage due to high volumes!



This headset is capable of producing high sound pressure levels. Higher volumes or longer durations can damage your hearing!

Set the volume to a medium level. Make sure that you can hear critical environmental sounds.

Switching ActiveGard™ on and off

ActiveGard™ safeguards your ears from volume peaks above 105 dB, which can be transmitted via the audio system or radio equipment. ActiveGard™ is factory-preset to “on”. You can switch ActiveGard™ off by gently sliding the switch to the upper position using a pointed tool.

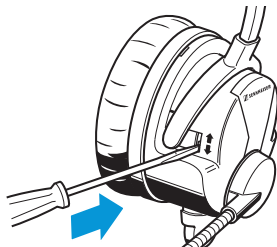

Care and maintenance

CAUTION! Liquids can damage the electronics of the product!



Liquids entering the housing of the product can cause a short-circuit and damage the electronics.

- ▶ Use only a slightly damp cloth to clean the product.
-

Cleaning the headset

Use a soft, slightly damp cloth to clean the headset from time to time. If the headset is very dirty, use a cloth dampened with mild, soapy water. Do not use any solvents or cleansing agents.

Replacing the ear pads

For reasons of hygiene, the ear pads should be replaced from time to time. Grasp the edge of the ear pad and pull sharply. Attach the new ear pad to the earcup by pressing firmly around the ear pad until you hear all latches lock into place. Repeat for the other earcup.

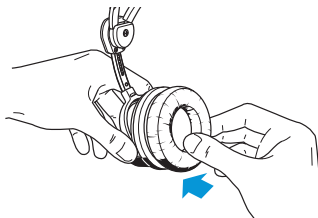
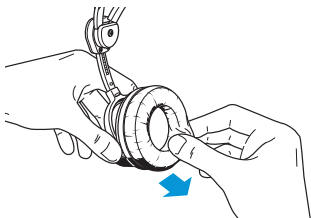

Cleaning the sound inlet basket

- ▶ Carefully pull the sound inlet basket from the capsule.
- ▶ Moisten a small brush (bristle brush or toothbrush) with isopropyl alcohol.
- ▶ Carefully brush off the sound inlet basket.
- ▶ Allow the sound inlet basket to air dry for approx. 1 hour so that the remaining isopropyl alcohol can evaporate.
- ▶ Reattach the sound inlet basket to the capsule so that it locks into place with an audible click.
When attaching the sound inlet basket, make sure not to cover the sound inlet.

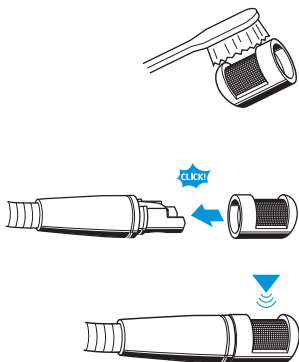

Accessories

Cat. No.	Cables *
500836	-6
502360	-7
502533	-H-6
502461	-X4F
502462	-X5
502459	-X3K1
502460	-X3K1-P48
502457	-H-X4F
502458	-H-X5
502456	-H-X3K1

Headband paddings

515629	1 pair
--------	--------

Ear pads

529766	leatherette, 1 pair
529767	leatherette, 100 pairs
532724	velour, 1 pair

HZH 26 hygiene pads

502595	white, 200 items
504062	black, 200 items

* By changing the cable, you can simply retrofit your headset (see "Product variants" on page 12).

Carry bags

077408 Carry bag

Wind and pop screens for BKE 4-4

535803 small (indoor use)
1 item

530895 small (indoor use)
any quantity

535804 large (outdoor use)
1 item

534729 large (outdoor use)
any quantity

Cable clips

044740 MZQ 2002

525787 HZC 08

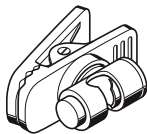

HZC 08
(for round cable only)



MZQ 2002
(for round or flat cable)

Product variants

Variant (Cat. No.) (Part Number)	Description
HME 26-100(4) (504203) (026-BC)	100 Ω per system, condenser microphone, cardioid
HME 26-600(4) (504204) (026-GC)	600 Ω per system, condenser microphone, cardioid

Cable and connector assignment

System connector

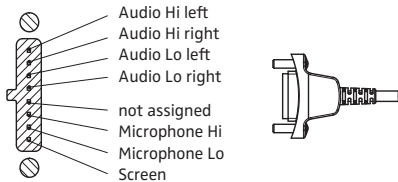

Cable -6

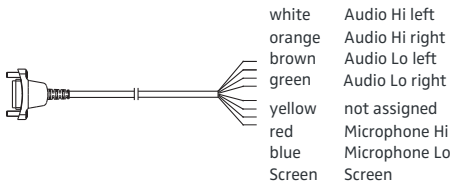

Cable -7 (steel wire cable)

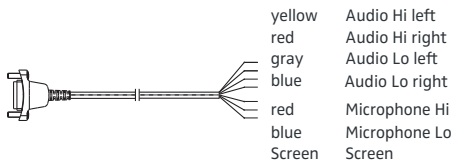

Cable -H-6

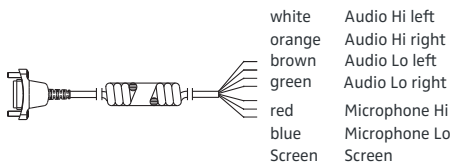

Cable -X4F/cable -H-X4F

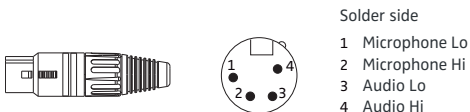

Cable -X5/cable -H-X5

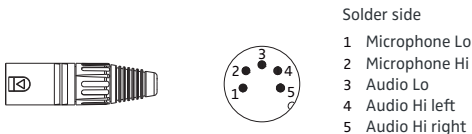

Cable -X3K1/cable -H-X3K1



XLR-3 connector



Solder side

- 1 Screen
- 2 Microphone Hi
- 3 Microphone Lo

1/4" (6.3 mm) jack plug

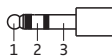

Solder side

- 1 Audio Hi left
- 2 Audio Hi right
- 3 Audio Lo

Cable -X3K1-P48*



XLR-3 connector



Solder side

- 1 Ground/screen
- 2 Microphone Hi/48 VDC
- 3 Microphone Lo/48 VDC

1/4" (6.3 mm) jack plug

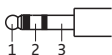

Solder side

- 1 Audio Hi left
- 2 Audio Hi right
- 3 Audio Lo

- * Together with the cable -X3K1-P48, the HME 26 is designed for P48 phantom powering as per DIN 45596.

Specifications HME 26-600(4)/-100(4)

Headphones

Transducer principle	dynamic, closed
Ear coupling	supra-aural
Frequency response	20 to 18,000 Hz
Impedance	
HME 26-600(4)	300 Ω mono/600 Ω stereo
HME 26-100(4)	50 Ω mono/100 Ω stereo
Characteristic SPL	105 dB SPL at 1 kHz, 1 mW
HME 26-600(4)	107 dB SPL at 1 kHz, 1 V
HME 26-100(4)	115 dB SPL at 1 kHz, 1 V (ActiveGard switched off)
Max. SPL	105 dB SPL at 1 kHz (ActiveGard switched on)
HME 26-600(4)	127 dB SPL at 1 kHz, 200 mW
HME 26-100(4)	128 dB SPL at 1 kHz, 200 mW (ActiveGard switched off)
THD	< 0.5 % at 1 kHz
Contact pressure	approx. 3.6 N

Microphone

Type	BKE 4-4
Transducer principle	pre-polarized condenser microphone, cardioid
Frequency response	40 to 20,000 Hz
Output voltage	4 mV/Pa \pm 2.5 dB
Terminating impedance	min. 4.7 k Ω
Supply voltage	5 to 15 V DC

General data

Ambient temperature	operation: -15 °C to 55 °C storage: -55 °C to 70 °C
Weight without cable	approx. 200 g

Manufacturer Declarations

Warranty

Sennheiser electronic GmbH & Co. KG gives a warranty of 24 months on this product.

For the current warranty conditions, please visit our website at www.sennheiser.com or contact your Sennheiser partner.

In compliance with

- RoHS Directive (2002/95/EC)

CE Declaration of Conformity

- **CE**
- EMC Directive (2004/108/EC)

The declarations are available at www.sennheiser.com.

Before putting the product into operation, please observe the respective country-specific regulations.



Sennheiser electronic GmbH & Co. KG
Am Labor 1, 30900 Wedemark, Germany
www.sennheiser.com

Printed in Germany
Publ. 07/09
535307/A01